



Declaration

In accordance with Part IV, Section 57 (2) of the Local Government (Planning and Development) Act, 2000 (as amended).

Louth County Council:

This declaration specifies what works would, or would not, in the opinion of the planning authority materially affect the character of the protected structure, or any element thereof, and, as a result, require planning permission. Under the Act, protection extends to the entire structure including its interior and the land lying within its curtilage. It also extends to any other structures lying within the curtilage of the protected structure, to their interiors and to all fixtures and features that form part of the interior or exterior of any of these structures. Where specified in the Record of Protected Structures, protection may also extend to any other feature within the attendant grounds of the protected structure.

Nothing in this declaration exempts works that would not otherwise be exempt from a requirement for planning permission. Changes of use or intensification of the current use may require planning permission. If in doubt, the owner/occupier should consult the planning authority for further advice before commencing any works.

This Declaration may be referred to An Bord Pleanála for review within 4 weeks of its issue, upon payment of the requisite fee in accordance with Part IV, Section 57 (8) of the Planning & Development Act 2000 as amended.

Applicant Name:	Cara Konig Brock		
Status (i.e. Owner or Occupier):	Owner Occupied		
Date of Request for Declaration:	10/02/2022	Date of Inspection:	N/A
Date of Issue of Declaration:	10/03/2022	Previous Declarations:	None on record

Address:

Name of Building:

Beaulieu House

Address 1:

Drogheda

Address 2:

Co. Louth

Address 3:

A92 PD3R

Location:

National Grid co-ordinates:

E N

O.S. Map Type:

Map Sheet:

Site Number:

Protection Status:

Y / N

Details:

Under the Planning and development Act 2000
(as amended)

Record of Protected Structures:

Y ✓ N

LHS 025-002

Architectural Conservation Area:

Y N x

Under the Planning and development Act 2000
(as amended)

Record of Monuments and Places:

Y N x

Zone of Archaeological potential:

Y N x

Preservation Order or Temporary P.O.:

Y N x



NIAH Registration No.: **13902509**



[View on map](#)

Survey Data

Reg No	13902509
Rating	National
Categories of Special Interest	Architectural, Artistic, Historical, Social
Original Use	Country house
In Use As	Country house
Date	1710 - 1720
Coordinates	312680, 276717
Date Recorded	19/07/2005
Date Updated	--/--/--

Description/Appraisal of the Structure:

This superb mansion, set in a wooded demesne, is built on lands which were granted to Sir Henry Tichbourne in 1642. Traditionally thought to have been built c. 1660, research suggests that the current house was built c. 1715. However, the style of the building, with its Dutch influenced dormers, chimneystacks and steep roofs, is old fashioned for that date. The superbly-crafted finely-jointed red brickwork dressings to openings is of particular note. Carved modillion cornice console brackets are well wrought. The steeply-pitched slated roof with projecting dormers gives the building a distinctive flavor.

Assessment:

The proposed works are described as 'the drilling of c. 6 samples (total) of roof and cellar timber to be drilled about the size of a short pencil length'. The wood is then examined in a lab at Queens University, Belfast, to verify its age through process of dendrochronology. Dating of the timbers is part of research being undertaken on the evolution of Beaulieu's architectural design during the 17th Century.

The Planning Authority considers that the works described are minimal and inconsequential in nature and would not materially affect the character of the protected structure.



Outline Schedule of Works:

The works described below can be undertaken without materially affecting the character of the protected structure;

- i) The drilling of 6 no. samples from roof and cellar timbers for the purposes dendrochronological dating.

Special Remarks:

The House dates from 1710-1720.

The House falls within four categories of interest as follows: Architectural, Artistic, Historic and Social.

Any further documentation attached (maps, photographs, sketches, notes etc.)? **Yes**

- Land Registry Folio Map showing site boundaries in red.
- 3 No. Photos of roof timbers where samples are to be taken from.
- Email from applicant Cara Konig Brock to Clare O'Hagan 04/02/2022 seeking advice.

Signed by Inspector

Signed by Planning Authority Officer

Brian McGeary (Assistant Planner)

Joanna Kelly (Senior Planner)

Date: 10/03/2022

Date:

LOUTH COUNTY COUNCIL

CHIEF EXECUTIVE'S ORDER

PLANNING & DEVELOPMENT ACT 2000 (as amended)

Section 57 Declaration – Works to a Protected Structure

Chief Executive's Order No: 235/2022

Reference No: S57 LHS22-03

Date Application Received: 10 February 2022

Description: The drilling of c. 6 samples (total) of roof and cellar timber to be drilled about the size of a short pencil length. The wood is then examined in a lab at Queens University, Belfast, to verify its age through process of dendrochronology.

Name of Applicant: Cara Konig Brock

Location of Development Beaulieu House, Drogheda, Co. Louth

WHEREAS the question has arisen as to whether the proposed works would or would not materially affect the character of protected structure or any element of the structure which contributes to its special architectural, historical, archaeological, artistic, cultural, scientific, social or technical interest at Beaulieu House, Drogheda, Co. Louth

AND WHEREAS Cara Konig Brock requested a declaration on the question from Louth County Council on the 10th February, 2022.

AND WHEREAS Louth County Council in considering this referral, had regard particularly to –

- (a) Section 2 of the Planning and Development Act 2000, as amended,
- (b) Section 3 of the Planning and Development Act 2000, as amended,
- (c) Section 4 (1)(h) of the Planning and Development Act 2000, as amended,

- (d) Section 57 of the Planning and Development Act, 2000 as amended,
- (e) Section 68 of the Planning and Development Act, 2000 as amended,
- (f) Section 77(1) of the Planning and Development Act 2000, as amended,
- (g) The Architectural Heritage Protection Guidelines for Planning Authorities,
- (h) The special interest pertaining to the protected structure in question and
- (i) The nature and extent of works set out in the referral question which seeks to address the safety concerns in respect of this structure,

AND WHEREAS Louth County Council has concluded that –

- (i) The works described are minimal and inconsequential in nature and would not materially affect the character of the protected structure.
- (ii) The works can be undertaken without materially affecting the character of the protected structure i.e. the drilling of 6 no. samples from roof and cellar timbers for the purposes dendrochronological dating.

NOW THEREFORE Louth County Council, in exercise of the powers conferred on it by Section 57 of the 2000 Act as amended, hereby decides that the proposed works to Beaulieu House, Drogheda, Co. Louth as detailed above, **constitutes development that is exempted development.**

SIGNED:

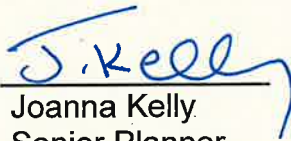

Joanna Kelly
Senior Planner

Dated: 16th March, 2022

ORDER:

In pursuance of the powers conferred upon the Council by the above Act, I concur with the above recommendation and I hereby direct that a **Section 57 Declaration of Exemption be Granted** for the works, as described above.

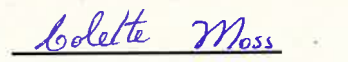
SIGNED:

Colette Moss
A/Director of Services

Dated: 16th March, 2022

To whom this function has been delegated in accordance with the provision of Sections 154 of the Local Government Act 2001 by Order no CE.S.106/22 dated the 2nd day of March, 2022.



Comhairle Contae Lú
Louth County Council

**PLANNING AND DEVELOPMENT ACT 2000
REQUEST FOR SECTION 57 DECLARATION
(PROTECTED STRUCTURE)**

The above Act provides that any works which would affect the character of a protected structure, or a proposed protected structure will require planning permission, even where those works would normally be exempt under Section 4 (1)(h) of the 2000 Act.

As an owner or occupier of a protected structure you are entitled under the above act to request the Council to issue a declaration as to the type of works which may or may not be permitted in your structure. In order to issue this declaration you should supply the following information:

1. Name of Applicant: __CARA KONIG BROCK
2. Address of Protected Structure: ___BEAULIEU HOUSE DROGHEDA LOUTH A92 PD3R
3. Correspondence address: (if different from 2 above) NA
4. NIAH Ref No. & Louth RPS Number **NIAH Reg No: 13902509**

LCC_RPS:Beaulieu House & Dem

RPS No: Lhs025-002

Status: Protected Structure

Name: Beaulieu House & Dem

Type: house

NIAH_No: 13902509

5. Is structure owner occupied or rented? OWNER OCCUPIED
6. If rented state name and address of owner: NA
7. Use of structure (residential, commercial etc.): __RESIDENTIAL
8. **Site location map** to the scale of 1:1000 clearly identifying the structure and boundaries to which the application refers (subject structure to be outlined in red, overall land holding to be outlined in blue)
9. Has a declaration been sought previously? __NOT AWARE OF ANY APPLICATION

I wish to apply for a declaration from Louth County Council as to the type of works which need permission in my structure.

PERMISSION IS BEING SOUGHT FOR C. 6 SAMPLES (TOTAL) OF ROOF AND CELLAR TIMBER TO BE DRILLED ABOUT THE SIZE OF A SHORT PENCIL LENGTH BY LEADING ACADEMIC IN THIS FIELD OF STUDY, DAVID BROWN. THIS WOOD IS THEN EXAMINED IN A LAB AT QUEENS UNIVERSITY, BELFAST, TO VERIFY ITS AGE THROUGH PROCESS OF DENDROCHRONOLOGY. DAVID BROWN IS:

- Research Fellow, **School of Natural and Built Environment**
- **Environmental Change and Resilience** AT QUEENS UNIVERSITY BELFAST

DATING OF THE TIMBERS IS PART OF RESEARCH BEING UNDERTAKEN BY PROF. BRUCE CAMPBELL AND DR. ANTHONY MALCOLMSON ON THE EVOLUTION OF BEAULIEU'S ARCHITECTURAL DESIGN DURING THE C17TH. THIS PAPER IS PROPOSED FOR PUBLICATION IN IGS JOURNAL AND IS CURRENTLY NEARING COMPLETION.

Signed: CARA KONIG BROCK

Date: FEB 10TH 2022

Cara König Brock

Daytime contact telephone Number:

It should be noted that the Council is normally obliged to issue this declaration within three months of the request being made and that you will be contacted within this period to arrange an appointment for a suitably qualified person to carry out a detailed survey of the internal and external features of the structure.

**Please return completed form to:
Conservation Office, Planning Dept. Louth County Council,
Town Hall, Crowe St, Dundalk, Co Louth
Email: conservation@louthcoco.ie**

ORTHOCENTRE POINT COORDINATES
712180.76888

DESCRIPTION

MAP SHEETS

1:1000
2319-A
1:2500
2319-B
2:2500-C
2320-A
2:2500-D



Ordnance Survey Ireland
OSi

OSi
The Ordnance Survey is the national mapping agency for Great Britain and Ireland. It is a non-departmental public body of the Home Office, and is part of the Home Office's Civil Service.

OSi
The Ordnance Survey is the national mapping agency for Great Britain and Ireland. It is a non-departmental public body of the Home Office, and is part of the Home Office's Civil Service.

OSi
The Ordnance Survey is the national mapping agency for Great Britain and Ireland. It is a non-departmental public body of the Home Office, and is part of the Home Office's Civil Service.

OSi
The Ordnance Survey is the national mapping agency for Great Britain and Ireland. It is a non-departmental public body of the Home Office, and is part of the Home Office's Civil Service.

OSi
The Ordnance Survey is the national mapping agency for Great Britain and Ireland. It is a non-departmental public body of the Home Office, and is part of the Home Office's Civil Service.

OSi
The Ordnance Survey is the national mapping agency for Great Britain and Ireland. It is a non-departmental public body of the Home Office, and is part of the Home Office's Civil Service.

OSi
The Ordnance Survey is the national mapping agency for Great Britain and Ireland. It is a non-departmental public body of the Home Office, and is part of the Home Office's Civil Service.

OSi
The Ordnance Survey is the national mapping agency for Great Britain and Ireland. It is a non-departmental public body of the Home Office, and is part of the Home Office's Civil Service.

OSi
The Ordnance Survey is the national mapping agency for Great Britain and Ireland. It is a non-departmental public body of the Home Office, and is part of the Home Office's Civil Service.

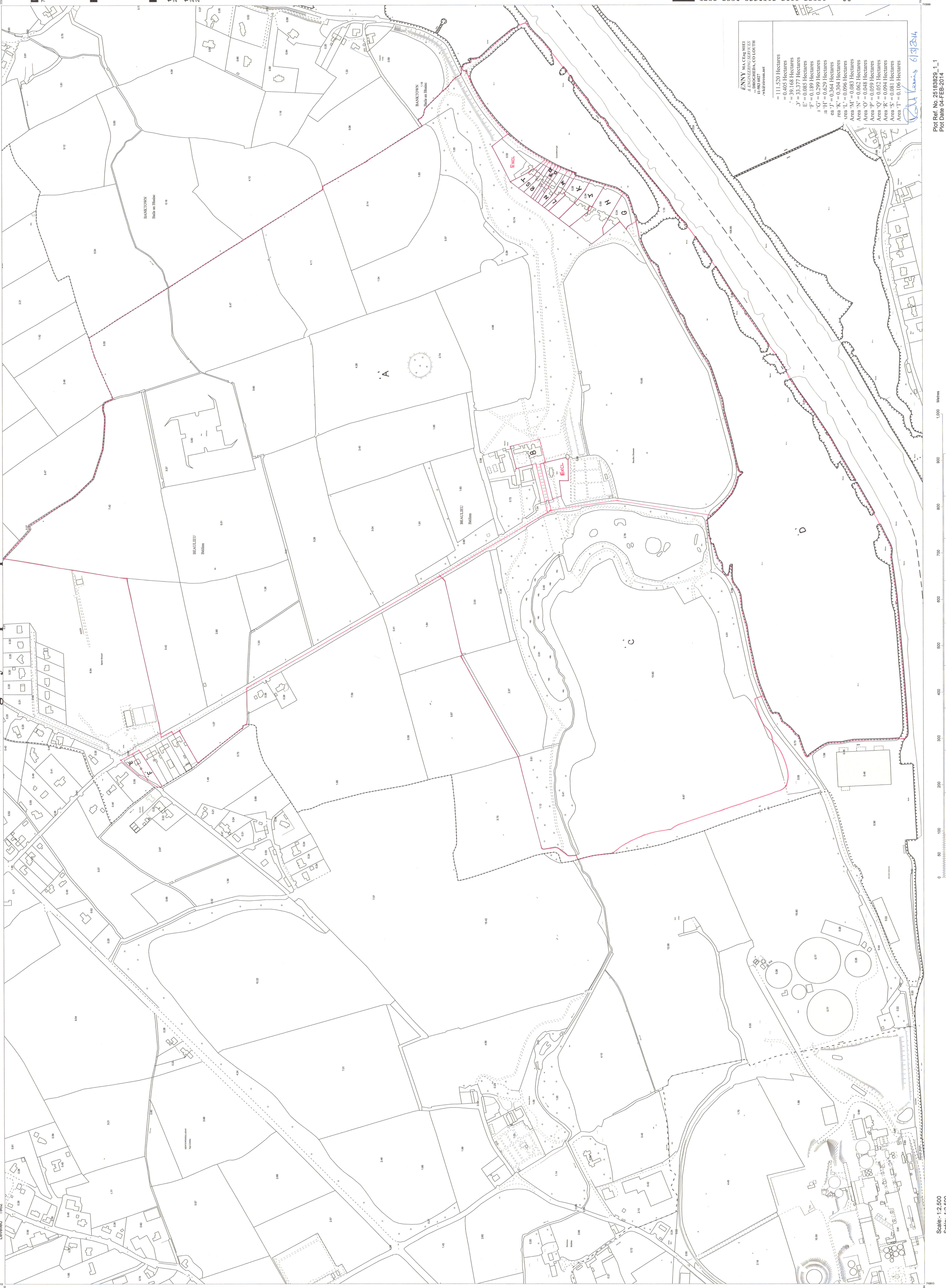

ENNY MACOMBE
A ENGINEERING SERVICES
14 BARRINGTON ROAD
DUBLIN 15, CO. DUBLIN

Area = 11.520 Hectares
Area A = 0.405 Hectares
Area B = 39.168 Hectares
Area C = 53.857 Hectares
Area D = 0.189 Hectares
Area E = 0.299 Hectares
Area F = 0.629 Hectares
Area G = 0.364 Hectares
Area H = 0.304 Hectares
Area I = 0.096 Hectares
Area J = 0.083 Hectares
Area K = 0.048 Hectares
Area L = 0.059 Hectares
Area M = 0.052 Hectares
Area N = 0.081 Hectares
Area O = 0.106 Hectares

OSI
6/3/2014

Plot Ref. No. 25185829_1_1
Plot Date 04-FEB-2014

Scale: 1:2,500
Scale: 1:2,500



S57 – Beaulieu House (Roof Timbers)



S57 – Beaulieu House (Roof Timbers)

