

20/10/20



**SUBMISSION**

**DRAFT LOUTH COUNTY DEVELOPMENT PLAN (DLCDP) 2021-2027**

Increase Clogherhead Town Boundary by 1.34 (as shown) at Chapel Road, Clogherhead to accommodate one off rural housing.

22<sup>nd</sup> October 2020

Kate Booth

Also on behalf of Jessica Booth and Adam Booth, of same address.

Kind regards,

K. Booth

Kate Booth

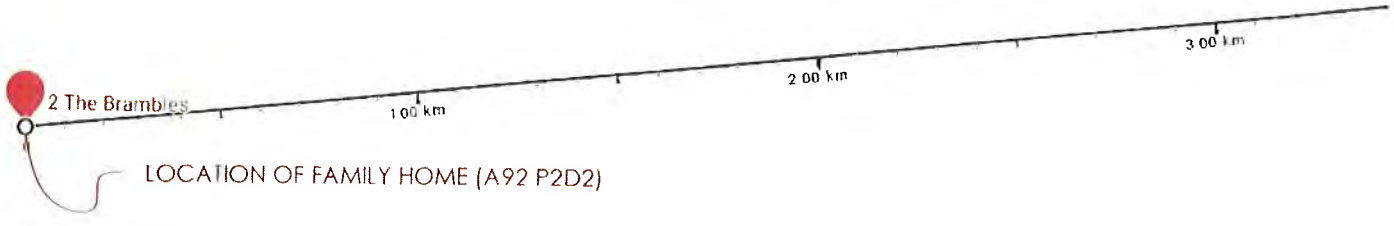

LOCATION OF FAMILY HOME  
SCALE: NTS

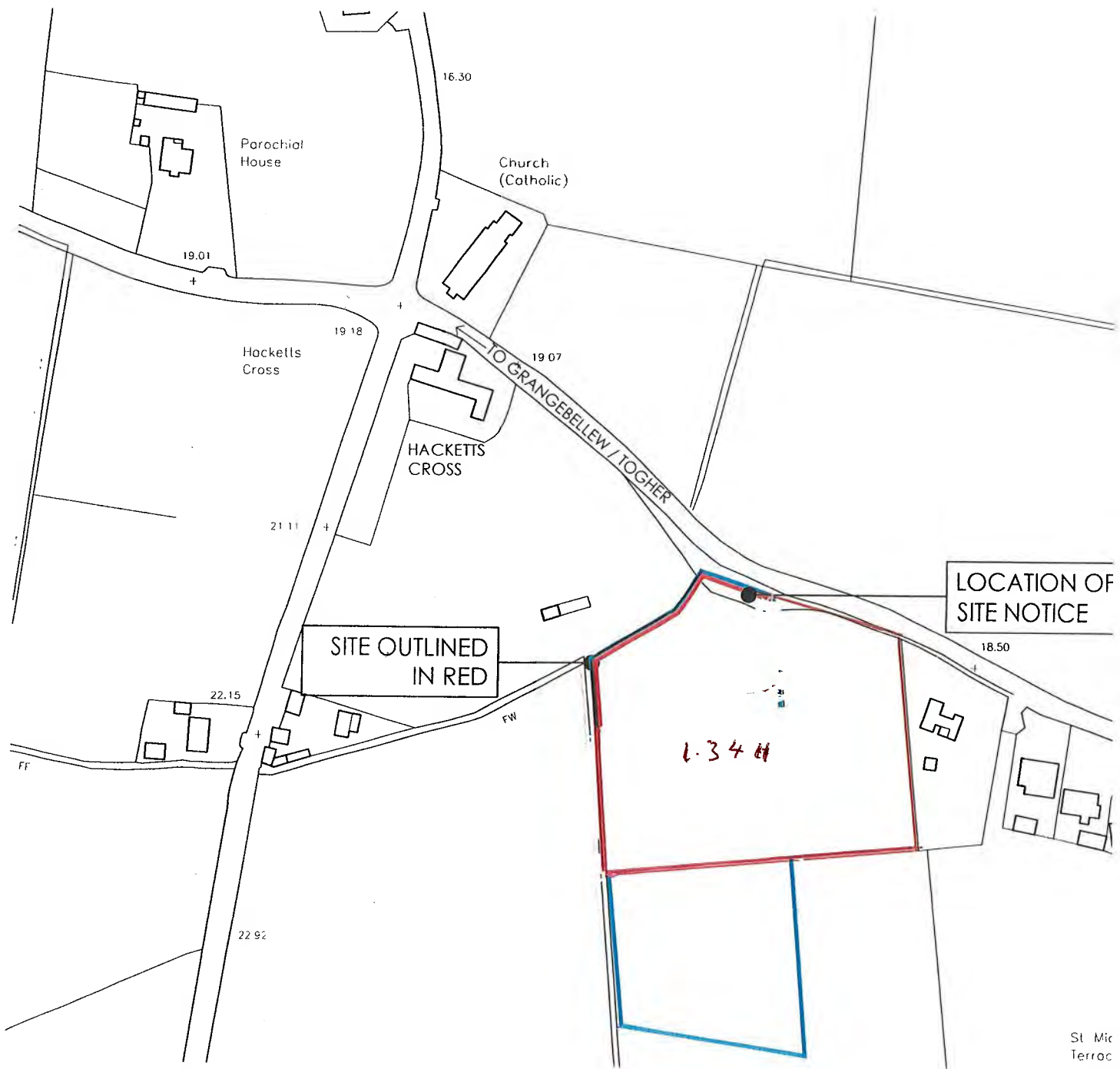

SITE LOCATION MAP  
SCALE 1:2500

