

Draft Louth County Development Plan 2021-2027

Pearse Mc Carragher []

Sent: 22 December 2020 16:33

To: LouthCDP

Attachments: Pearse McCarragher - Mapping.pdf (1 MB)

A Chara

In relation to the Draft Louth County Development Plan 2021-2027 I wish to make the following submission.

I with my family live in the Development centre of Ballagan and have done for generations. I own lands adjacent to the development centre boundary and I wish to have the boundary moved to include the proposed site which I have earmarked for some of my 4 children. Attached is map showing the location of my home, the proposed site and location of dwelling that I wish to have included in the development centre. My dwelling is owned under Folio Number [redacted] and Eircode is [redacted] while the proposed site is owned by me under Folio [redacted]

If for some reason this site cannot be included in the development centre we would ask that the current criteria be changed to allow my children build on this site even though it the outside the boundary and within 300m of the boundary.



I hope you take these comments into consideration.

Kind regards

Pearse McCarragher



OPW PFRAM Study

-  Flood Zone A
-  Flood Zone B

Settlement Boundary



Osi Vector Mapping

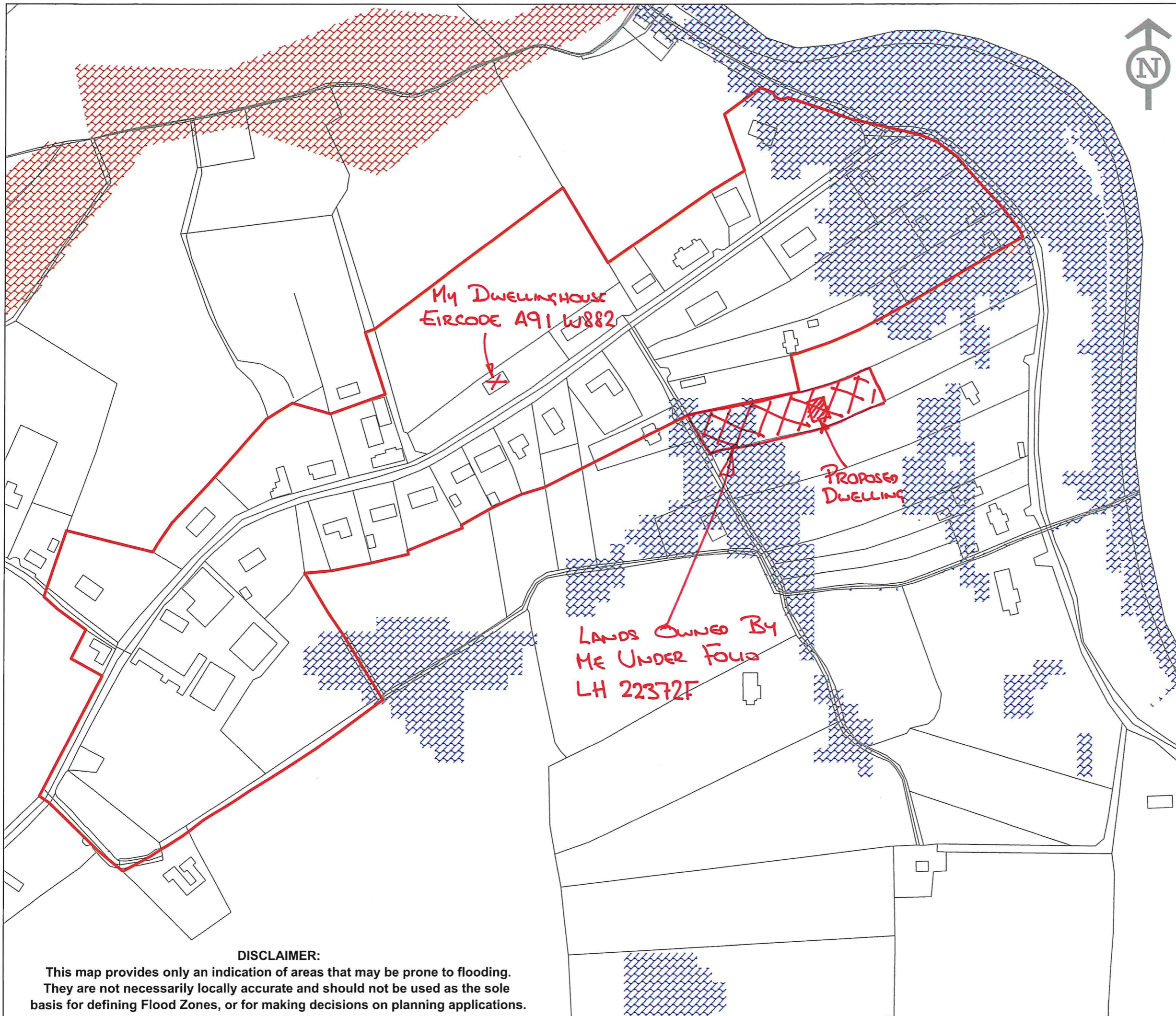
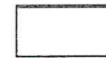

DISCLAIMER:

This map provides only an indication of areas that may be prone to flooding. They are not necessarily locally accurate and should not be used as the sole basis for defining Flood Zones, or for making decisions on planning applications.

