

**Minimum Design Parameters for Level 1 Roads - Single Carriageway 50km/h**

Design Parameter	Type A - > 12 Hours	Type B - < 12 Hours	Type C - < 15 Mins
<b>ADVANCE WARNING SIGNAGE</b>			
Sign Size (mm)	600	600	-
Sign visibility (m)	50	50	50
Number of Signs	2	2	-
Cumulative Distance (m)	40	40	-
Distance between advance signs (m)	20	20	-
<b>TAPER</b>			
Lane taper rate	1 in 5	1 in 5	-
Hard shoulder taper rate	1 in 5	1 in 5	-
<b>CONES</b>			
Cone Height (mm)	750	750	-
Taper Spacing <sup>a</sup>	3	3	-
Longitudinal Spacing (m) <sup>a</sup>	3	3	-
<b>LAMPS (unlit areas only)</b>			
Taper Spacing (m)	6	6	-
Longitudinal Spacing (m)	6	6	-
<b>SAFETY ZONES</b>			
Longitudinal (m)	5	5	-
Lateral (m)	0.5	0.5	-
<b>LANES</b>			
Lane width (m) <sup>c</sup>	3 (2.5)	3 (2.5)	-
Two-way Roadway Width (m)	5	5	-

A. - 45 degree taper is required at shuttle traffic controlled layouts with cones at 1m centres.  
 B. - Cone spacing is the maximum permitted, where geometry or any other site specific reason dictates, the spacing shall be reduced accordingly.  
 C. - The optimum lane width for all classes of vehicles is 3.3m. this may be reduced to a minimum of 3m. Below this, HGVs and busses must be marshalled past the works. The absolute minimum lane width, if only cars and light vehicles are present, is 2.5m. Refer to section 0.3.3.2 of Part 0.

**Street View:**



Lane 2 Closure or Shuttle Lane

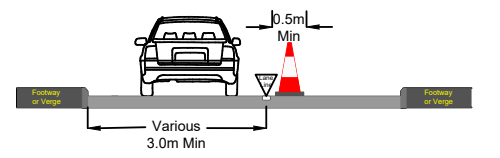

**KEY :**

- Safety Zone
- Works Area
- Pedestrian Ramp
- Sign Symbol
- Pedestrian Barrier Symbol
- Pedestrian Diversion Route

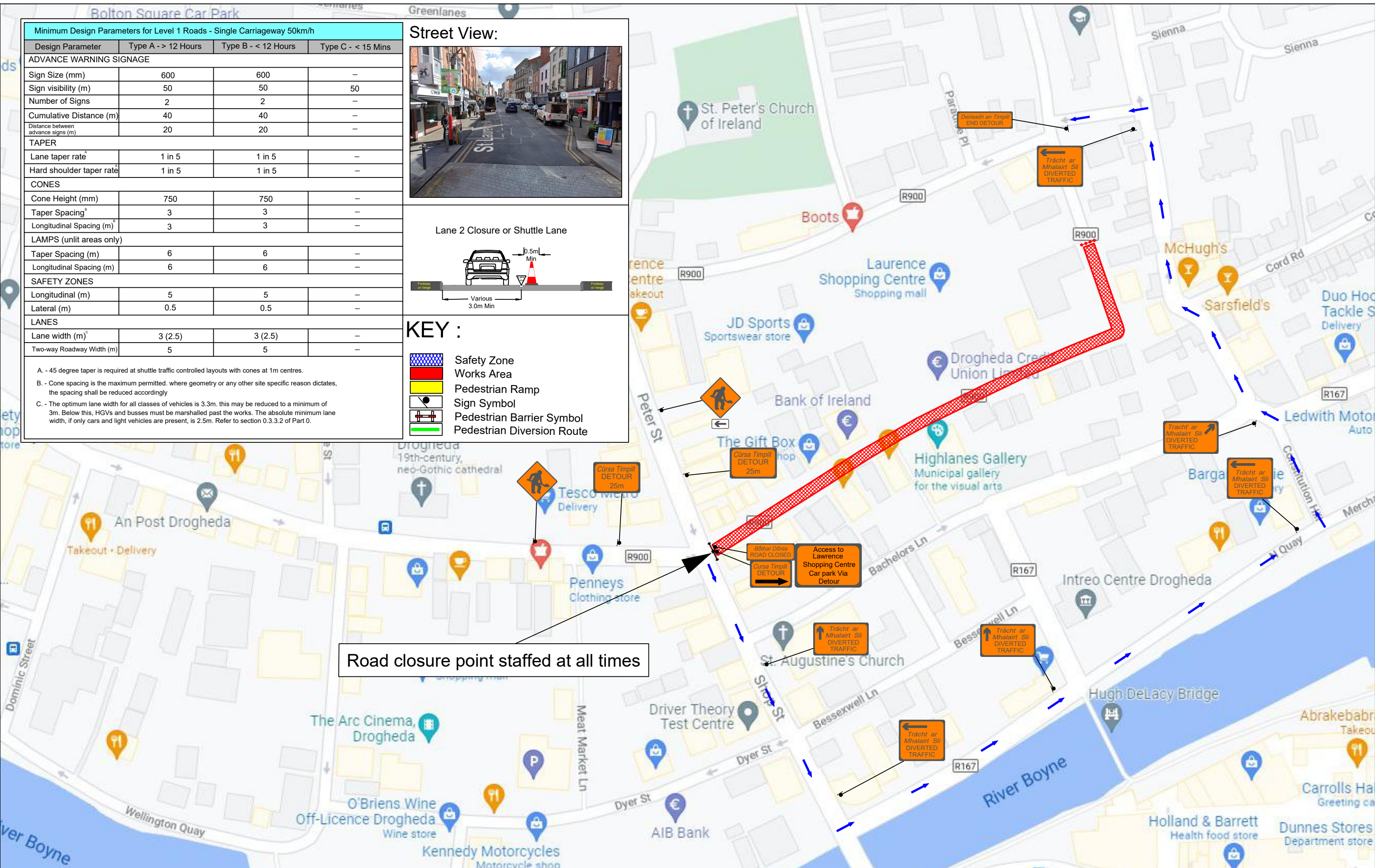

Road closure point staffed at all times

**NOTES:**  
 1. All traffic management to be in accordance with Chapter 8 of the Traffic Signs Manual.  
 2. All signs will comply with Traffic Sign Regulations in General Directions (TSRGD) 2002  
 3. Installation, maintenance and removal of traffic management will be carried out by Lantra approved operatives who have achieved Sector Scheme 12D training/ SLG Training

**PROJECT:**  
 Drogheda Motor Show  
**St Laurence Street, Drogheda**  
 Road closure & Detour

**PROJECT:**  
 Drogheda Motor Show  
 DRAWN: J.Lockhart CHECKED BY: S.Hallett  
 SCALE Not to scale DIMENSIONS Metres

Drg No: 001  
 Original Drawing Size A3

Edentober,  
 Carrickcarnon,  
 Dundalk,  
 Co.Louth  
 T:042 9358119