



Notes

- Default Speed Limits as listed below apply to all public roads unless stated otherwise in Louth Road Traffic Special Speed Limit Bye-Laws 2018.

Default Speed Limits

- Motorway (M) - 120 km/h
- National Roads (N, NP, NS) - 100 km/h
- Regional Roads - 80 km/h
- Local Roads (LP, LS, LT) - 80 km/h
- Built-up Area - 50 km/h
(P - Primary, S - Secondary, T - Tertiary)

Legend

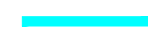
 30km/h - Periodic

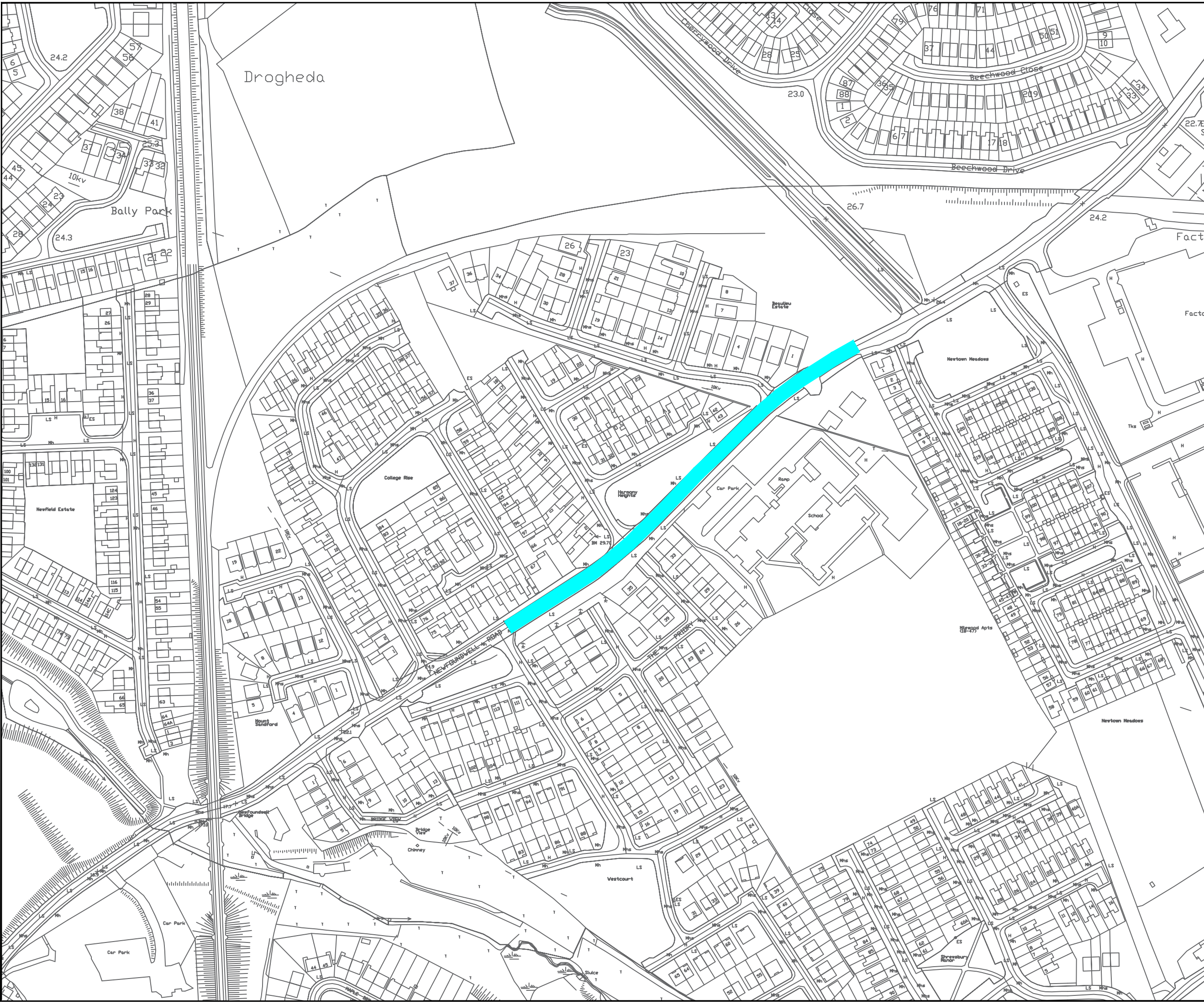

Comhairle Contae Lú
Louth County Council
 Town Hall, Crowe St.,
 Dundalk, County Louth
 A91 W20C
 Phone 042 9351310 (Inhabituare)

Scheme: **Periodic Speed Limits - Schools 2021**

Title: **St Joseph's Secondary School
Periodic Speed Limit**

Designed: .	Checked: PC
Drawn: SOH	Approved: JOH

Date: March 2021	Dr. No.
Scale: 1:2500(A3)	SL-112-2021

© Ordnance Survey Ireland. All rights reserved.
OSI Licence Number: 2011/30/CCMA/Louth County Council