



BOYNE ENTERPRISE ROAD EXTENSION



BOYNE ENTERPRISE ROAD EXTENSION

DRAWING NO.

L320-OCSC-XX-XX-DR-C-0001
L320-OCSC-XX-XX-DR-C-0002
L320-OCSC-XX-XX-DR-C-0003
L320-OCSC-XX-XX-DR-C-0004
L320-OCSC-XX-XX-DR-C-0005

TITLE

SITE LOCATION MAP
OVERALL SITE PLAN
TYPICAL CROSS SECTIONS
PROPOSED ROAD MARKING AND SIGNAGE
LAYOUT PLAN AND LONGITUDINAL SECTION

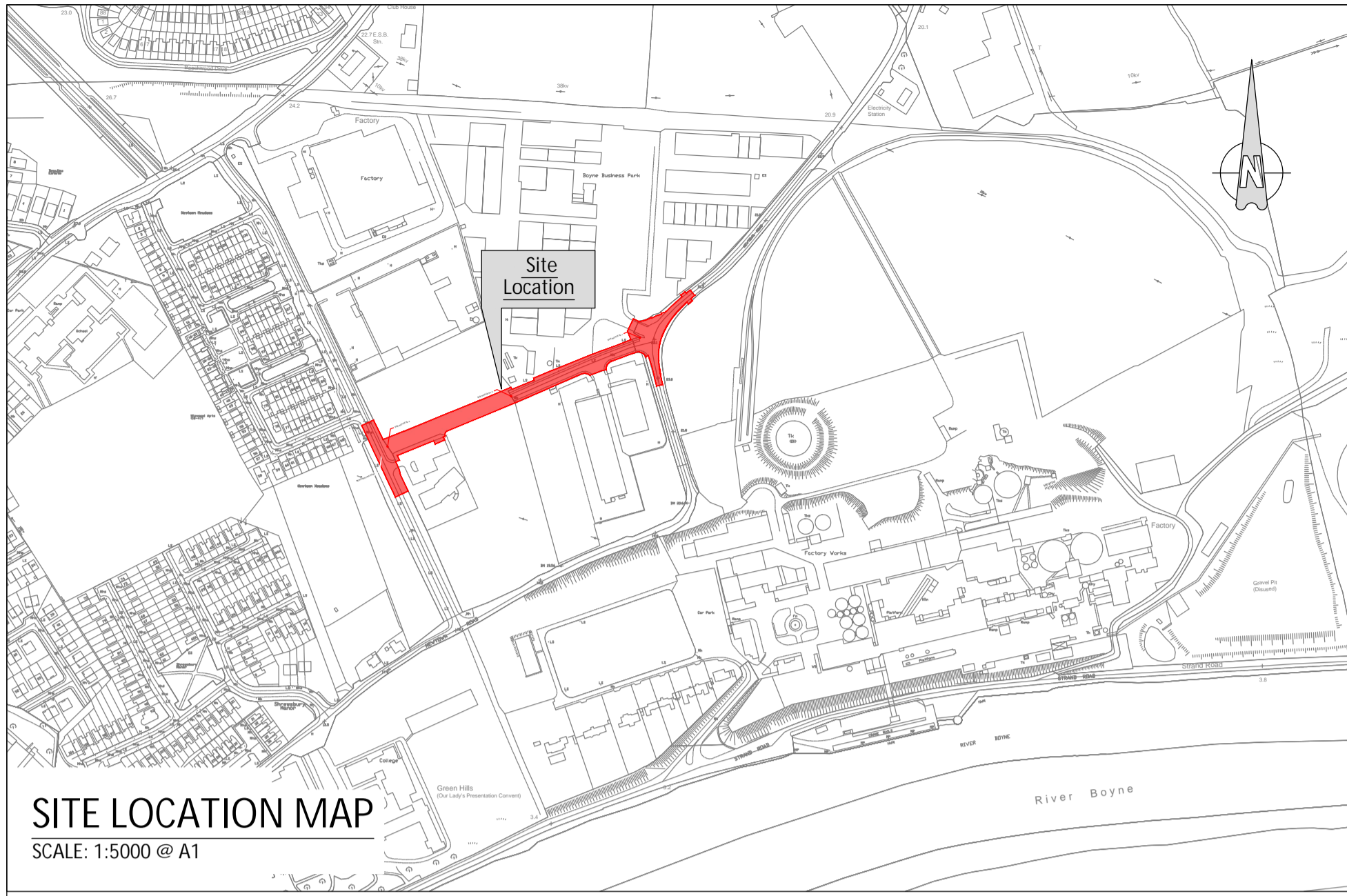

SITE LOCATION MAP
SCALE: 1:5000 @ A1

LEGEND

SITE BOUNDARY	
---------------	--



SITE LOCATION MAP
SCALE: 1:500 @ A1

THIS DRAWING TO BE READ IN CONJUNCTION WITH ALL OTHER ARCHITECTURAL AND ENGINEERING DRAWINGS AND ALL OTHER RELEVANT DRAWINGS AND SPECIFICATIONS.
DO NOT SCALE THIS DRAWING. USE FIGURED DIMENSIONS ONLY.
NO PART OF THIS DOCUMENT MAY BE REPRODUCED OR TRANSMITTED IN ANY FORM OR STORED IN ANY RETRIEVAL SYSTEM OF ANY NATURE WITHOUT THE WRITTEN PERMISSION OF O'CONNOR SUTTON CRONIN AS COPYRIGHT HOLDER EXCEPT AS AGREED FOR USE ON THE PROJECT FOR WHICH THE DOCUMENT WAS ORIGINALLY ISSUED.

Rev No.	Date	Revision Note	Drn by	Chkd by
P01	14.05.21	SUITABLE FOR INFORMATION	RF	JM
P02	14.05.21	UPDATED CREST	JM	BH
P03	14.05.21	PART 8 DRAWINGS	JM	BH

Rev No.	Date	Revision Note	Drn by	Chkd by



Head Office,
9 Prussia Street,
Dublin 7,
D07 K157

TEL +353 (0)1 8682000
e: contactus@ocsc.ie
w: www.ocsc.ie

Dublin | London | Belfast | Galway | Cork | Birmingham



Client: LOUTH COUNTY COUNCIL
Project: BOYNE ENTERPRISE ROAD EXTENSION

Title: PART 8 DRAWINGS
SITE LOCATION MAP

Code	Originator	Zone	Level	Type	Role	Number	Status	Revision
L320	OCSC	XX	XX	DR	C	0001	S2	P03

Date: 22.02.21 Scale: 1:500 @ A1 Drn by:LS Chkd by:JM Aprvd by:BOR

LEGEND

SITE BOUNDARY	
NEW ROAD FULL CONSTRUCTION	
ROAD INLAYED	
PROPOSED FOOTPATH	
PROPOSED FOOTPATH TO BE RECONSTRUCTION	
PROPOSED VERGE	
PROPOSED CONCRETE KERBS	
PROPOSED GATEWAY TYPE A	

NOTES:
FOR TYPICAL CROSSSECTION DETAILS, REFER TO A DRAWING L320-OCSC-XX-XX-DR-C-0004

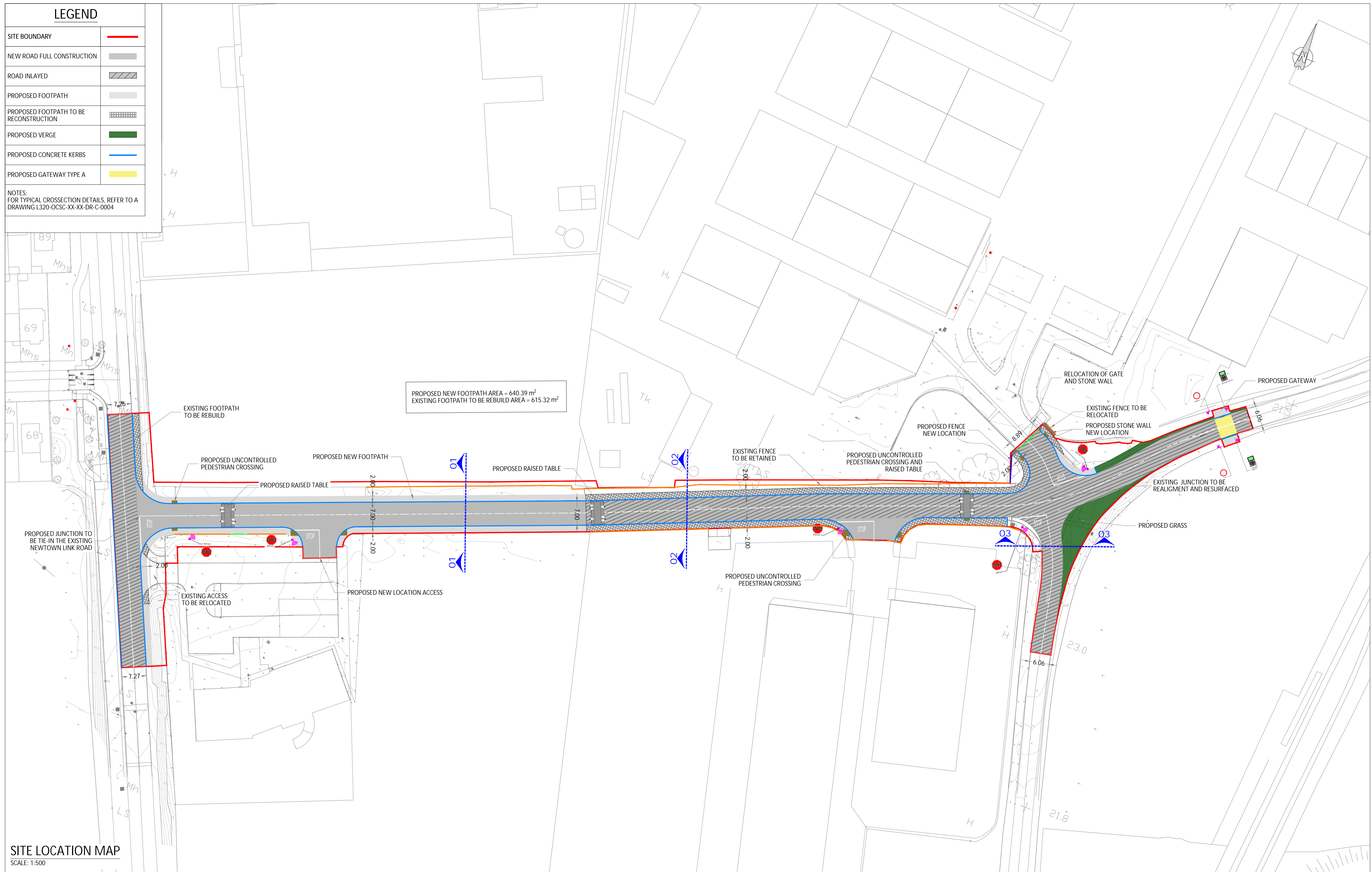

SITE LOCATION MAP
SCALE: 1:500

THIS DRAWING TO BE READ IN CONJUNCTION WITH ALL OTHER ARCHITECTURAL AND ENGINEERING DRAWINGS AND ALL OTHER RELEVANT DRAWINGS AND SPECIFICATIONS.
DO NOT SCALE THIS DRAWING. USE FIGURED DIMENSIONS ONLY.
NO PART OF THIS DOCUMENT MAY BE REPRODUCED OR TRANSMITTED IN ANY FORM OR STORED IN ANY RETRIEVAL SYSTEM OF ANY NATURE WITHOUT THE WRITTEN PERMISSION OF O'CONNOR SUTTON CRONIN AS COPYRIGHT HOLDER EXCEPT AS AGREED FOR USE ON THE PROJECT FOR WHICH THE DOCUMENT WAS ORIGINALLY ISSUED.

Rev No.	Date	Revision Note	Drn by	Chkd by
P01	14.05.21	SUITABLE FOR INFORMATION	RF	JM
P02	14.05.21	UPDATED CREST	JM	BH
P03	14.05.21	PART 8 DRAWINGS	JM	BH

Rev No.	Date	Revision Note	Drn by	Chkd by



Head Office,
9 Prussia Street,
Dublin 7,
D07 K157

TEL +353 (0)1 8682000
e: contactus@ocsc.ie
w: www.ocsc.ie

Dublin | London | Belfast | Galway | Cork | Birmingham



Client: LOUTH COUNTY COUNCIL
Project: BOYNE ENTERPRISE ROAD EXTENSION

Title: PART 8 DRAWINGS
OVERALL SITE PLAN

Code	Originator	Zone	Level	Type	Role	Number	Status	Revision
L320-OCSC-XX-XX-DR-C-0002							S2	P03

Date: 22.02.21 Scale: 1:500 @ A1 Drn by:RF Chkd by:JM Aprvd by:BO'R

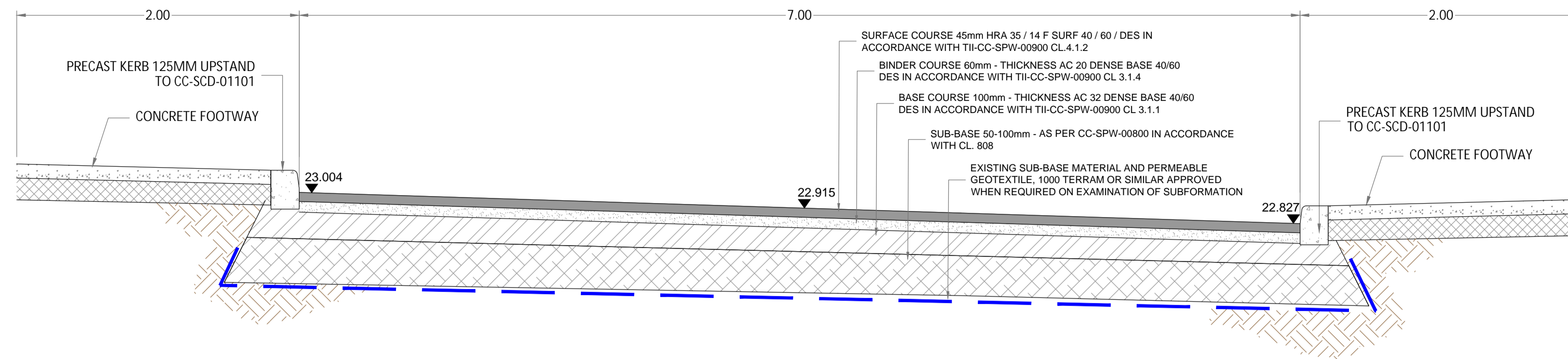

TYPICAL CROSS-SECTION 01-01: PROPOSED BOYNE ENTERPRISE CENTRE ROAD EXTENSION
SCALE 1:25

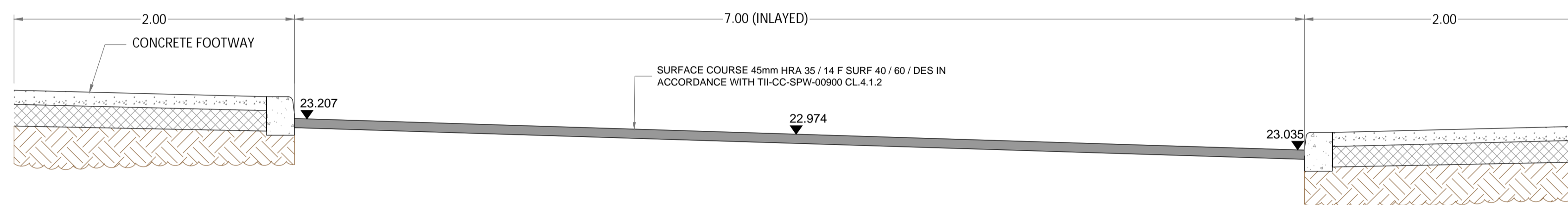

TYPICAL CROSS-SECTION 02-02: PROPOSED INLAYED BOYNE ENTERPRISE CENTRE ROAD
SCALE 1:25

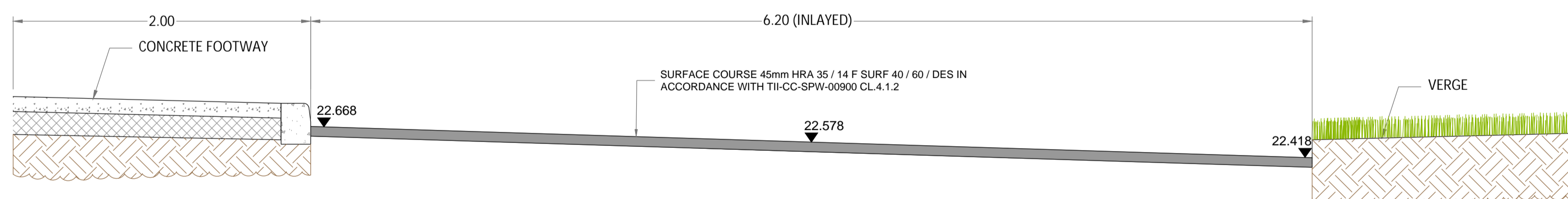

TYPICAL CROSS-SECTION 03-03: PROPOSED INLAYED BOYNE ENTERPRISE CENTRE ROAD
SCALE 1:25

ROAD PAVEMENT 100mm OVERLAY

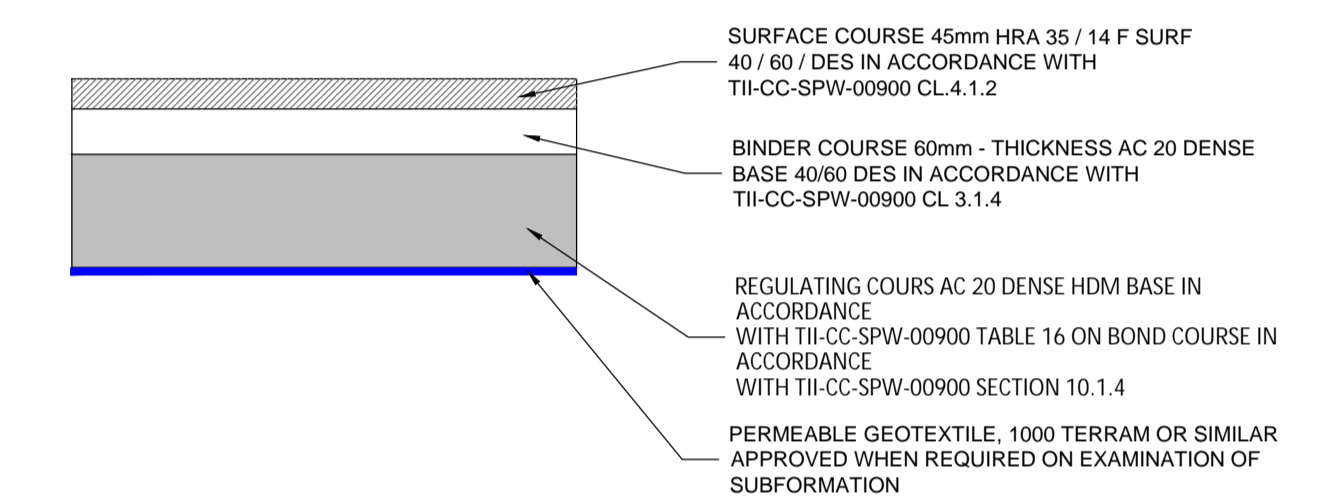

CARRIAGEWAY BUILD-UP

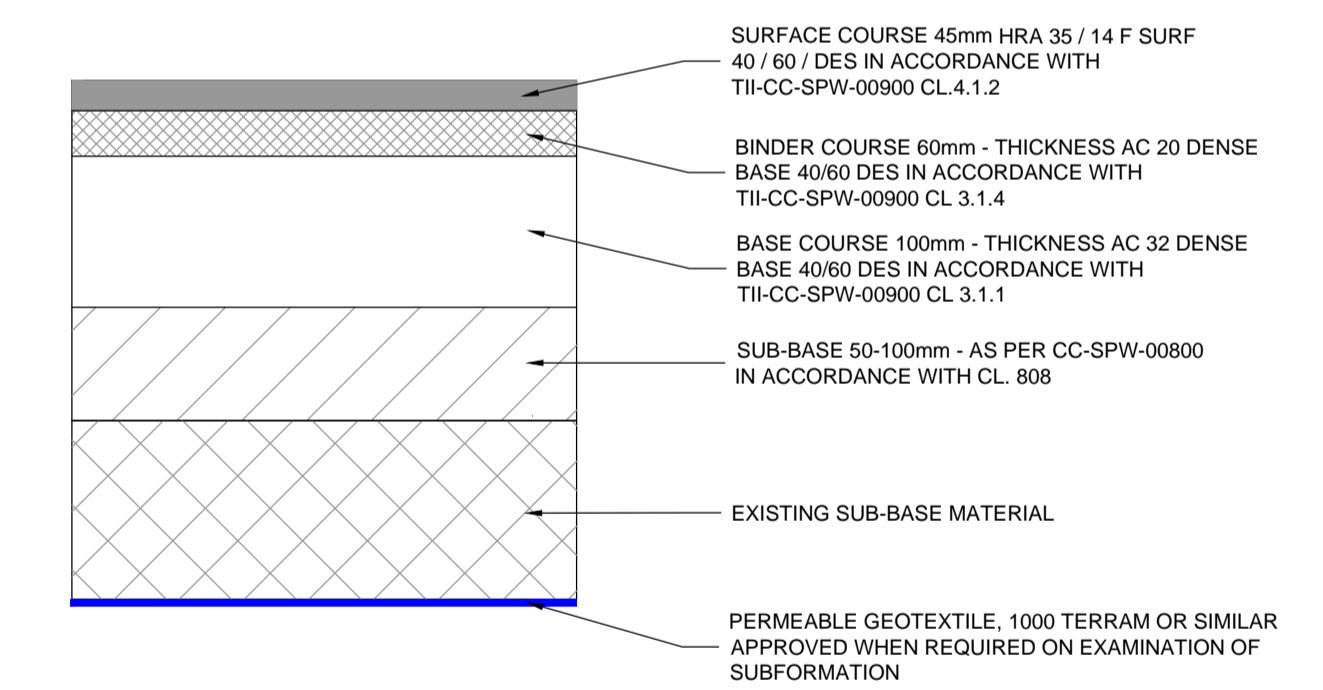

TABLE 1: CAPPING LAYER DEPTH

THE MINIMUM REQUIRED THICKNESS OF NON-FROST SUSCEPTIBLE CAPPING MATERIAL IS SHOWN HEREUNDER:

CBR SUBGRADE (%)	<2.5	2.5	3	4	5-15	>15
THICKNESS OF CAPPING LAYER (mm)	SPECIALIST GEOTECHNICAL ADVISE REQUIRED	600	350	300	250	150

CBR TESTS SHALL BE CARRIED OUT AT A RATE OF ONE TEST PER 100 METERS OF ROAD OR WHERE THE SOIL TYPE CHANGES

THIS DRAWING TO BE READ IN CONJUNCTION WITH ALL OTHER ARCHITECTURAL AND ENGINEERING DRAWINGS AND ALL OTHER RELEVANT DRAWINGS AND SPECIFICATIONS.
DO NOT SCALE THIS DRAWING. USE FIGURED DIMENSIONS ONLY.
NO PART OF THIS DOCUMENT MAY BE REPRODUCED OR TRANSMITTED IN ANY FORM OR STORED IN ANY RETRIEVAL SYSTEM OF ANY NATURE WITHOUT THE WRITTEN PERMISSION OF O'CONNOR SUTTON CRONIN AS COPYRIGHT HOLDER EXCEPT AS AGREED FOR USE ON THE PROJECT FOR WHICH THE DOCUMENT WAS ORIGINALLY ISSUED.

Rev No.	Date	Revision Note	Drn by	Chkd by	Rev No.	Date	Revision Note	Drn by	Chkd by
P01	14.05.21	SUITABLE FOR INFORMATION	RF	JM					
P02	14.05.21	UPDATED CREST	JM	BH					
P03	14.05.21	PART 8 DRAWINGS	JM	BH					



Head Office,
9 Prussia Street,
Dublin 7,
D07 K157

TEL +353 (0)1 8682000
e: contactus@ocsc.ie
w: www.ocsc.ie



Client: LOUTH COUNTY COUNCIL
Project: BOYNE ENTERPRISE ROAD EXTENSION

Title: PART 8 DRAWINGS
TYPICAL CROSS SECTIONS

Code | Originator | Zone | Level | Type | Role | Number | Status | Revision
L320 - OCSC - XX - XX - DR - C - 0003 | S2 | P03
Date: 22.02.21 Scale: 1:25 @ A1 Drn by:LS Chkd by:JM Aprvd by:BO'R

LEGEND

SITE BOUNDARY			
PROPOSED ROAD SURFACE			
PROPOSED CONCRETE KERBS			
POLES			
SIGNS	QUANTITY		
PROPOSED 3.3 m GALVANIZED SIGN POST	5 No		
TRAFFIC SIGNS			
SIGNS	SIZE	TSM REF.	QUANTITY
	750 mm	STOP SIGN - RUS 027	5 No
	750 mm	SING - RUS042	2 No
		GATEWAY SIGN A	2 No
NOTES: 1- ALL ROAD MARKINGS IN ACCORDANCE WITH TSM 2- FOR POLE CONSTRUCTION DETAILS, REFER TO DRAWING L320-OCSC-ZZ-XX-DR-C-1201			
ROAD MARKINGS LEGEND			
LEGEND			
PROPOSED STOP LINE 300mm WIDE REF: TSM RRM 017		48m.	
PROPOSED WORDED 'STOP' MARKING REF: TSM M114		5 No	
PROPOSED CONTINUOUS SINGLE CENTRE LINE 100mm WIDE REF: TSM -RRM 001		55m.	
RAISED TABLE		3 No	
TACTILE PAVING			
SIGNS	QUANTITY		
YELLOW COLOURED TACTILE PAVING TO UNCONTROLLED PEDESTRIAN CROSSING	40 m2		

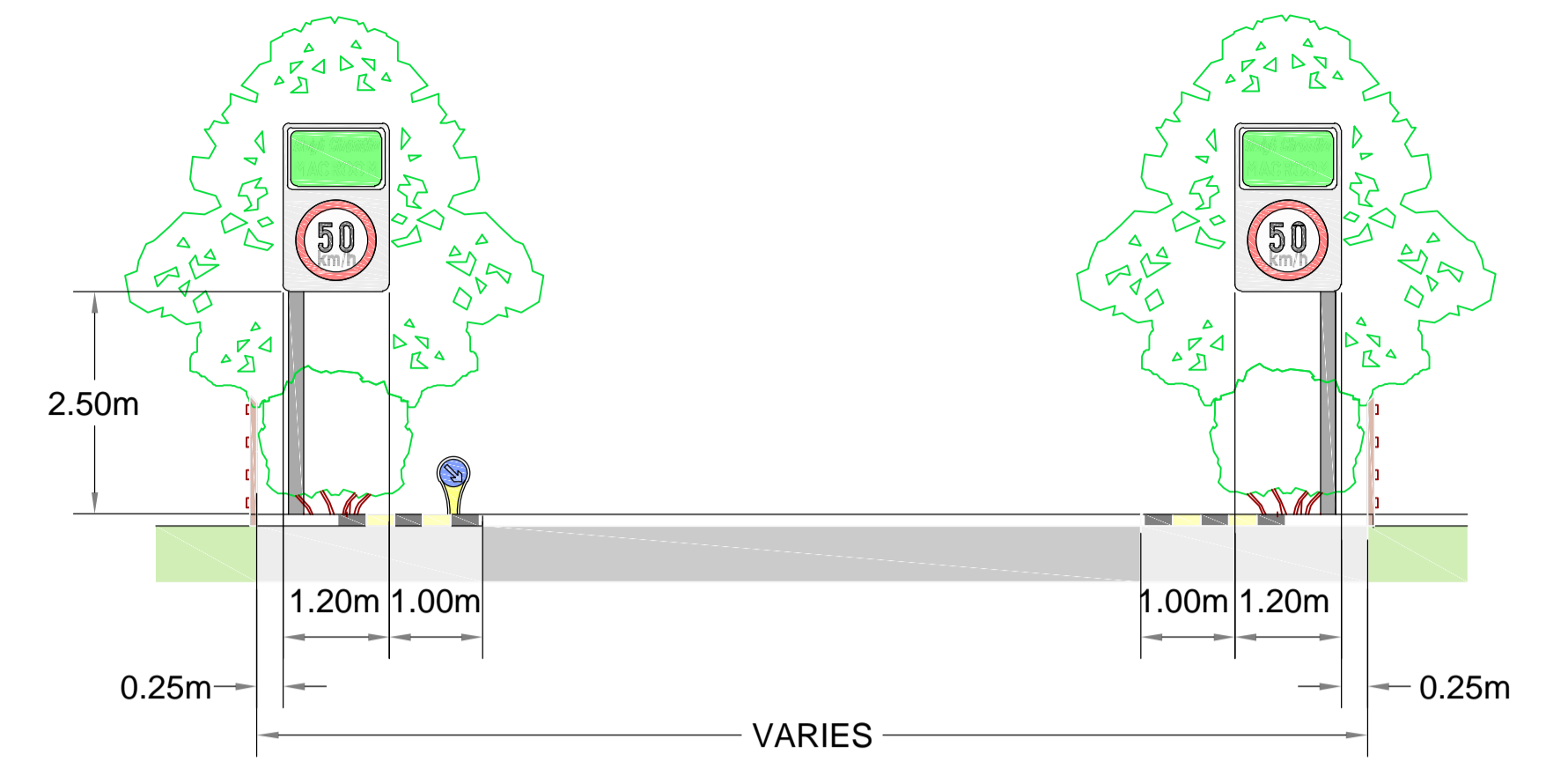

CC-SCD-05003 - GATEWAY TYPE 'A' ELEVATION
SCALE 1:75

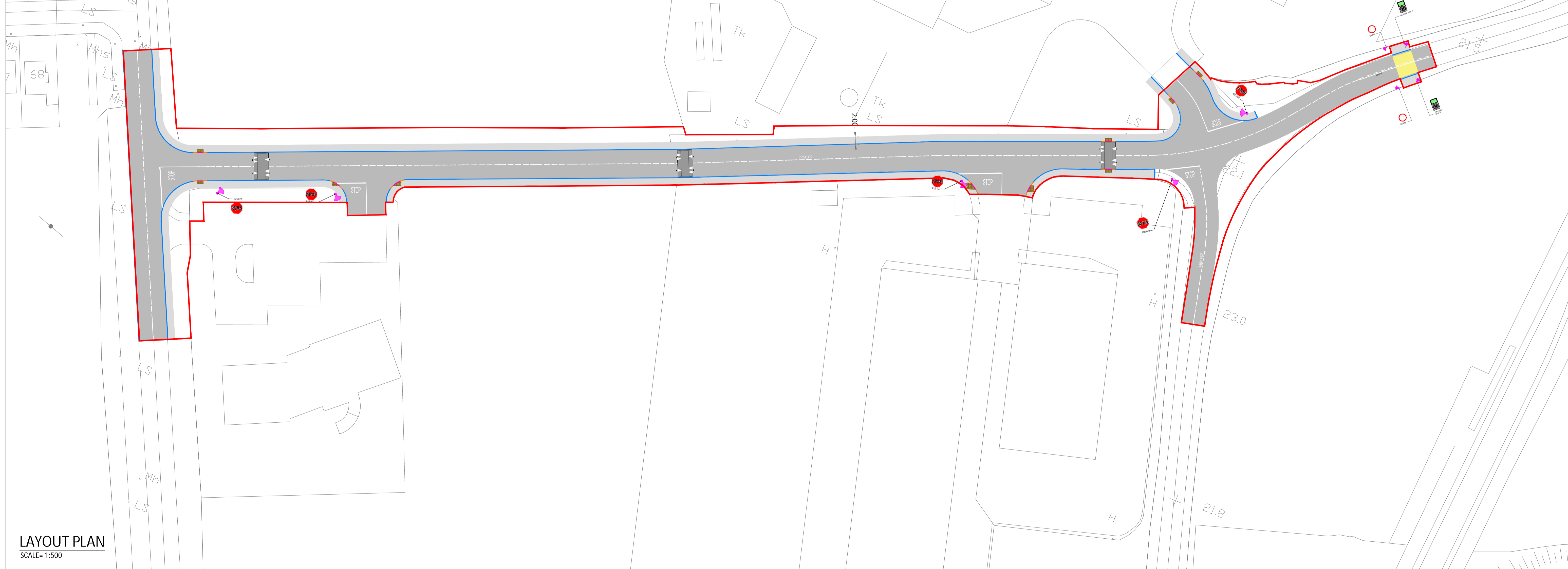

LAYOUT PLAN
SCALE= 1:500

Rev No.	Date	Revision Note	Drn by	Chkd by	Rev No.	Date	Revision Note	Drn by	Chkd by
P01	14.05.21	SUITABLE FOR INFORMATION	RF	JM					
P02	14.05.21	UPDATED CREST	JM	BH					
P03	14.05.21	PART 8 DRAWINGS	JM	BH					

THIS DRAWING TO BE READ IN CONJUNCTION WITH ALL OTHER ARCHITECTURAL AND ENGINEERING DRAWINGS AND ALL OTHER RELEVANT DRAWINGS AND SPECIFICATIONS.
DO NOT SCALE THIS DRAWING. USE FIGURED DIMENSIONS ONLY.
NO PART OF THIS DOCUMENT MAY BE REPRODUCED OR TRANSMITTED IN ANY FORM OR STORED IN ANY RETRIEVAL SYSTEM OF ANY NATURE WITHOUT THE WRITTEN PERMISSION OF O'CONNOR SUTTON CRONIN AS COPYRIGHT HOLDER EXCEPT AS AGREED FOR USE ON THE PROJECT FOR WHICH THE DOCUMENT WAS ORIGINALLY ISSUED.

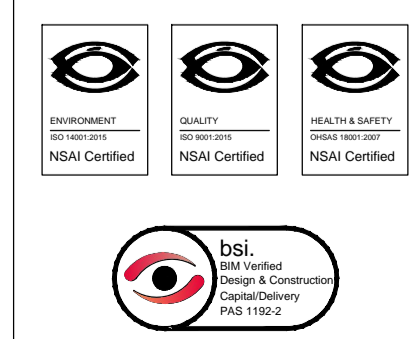

Head Office,
9 Prussia Street,
Dublin 7,
D07 K157

TEL +353 (0)1 8682000
e: contactus@ocsc.ie
w: www.ocsc.ie



Dublin | London | Belfast | Galway | Cork | Birmingham

Client: LOUTH COUNTY COUNCIL
Project: BOYNE ENTERPRISE ROAD EXTENSION

Title: PART 8 DRAWINGS
PROPOSED ROAD MARKINGS AND SIGNAGE

Code	Originator	Zone	Level	Type	Role	Number	Status	Revision
L320-OCSC	XX	XX	DR	C	0004	S2	P03	
Date: 22.02.21 Scale: 1:500 @ A1 Drn by:LS Chkd by:JM Aprvd by:BO'R								

LAYOUT PLAN
SCALE= 1:500

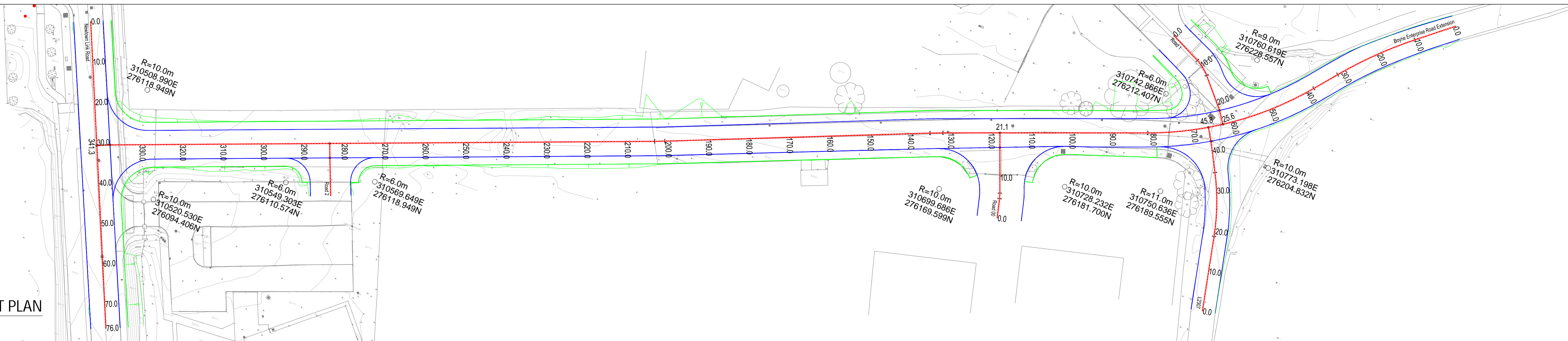

Boyne Enterprise Road Extension

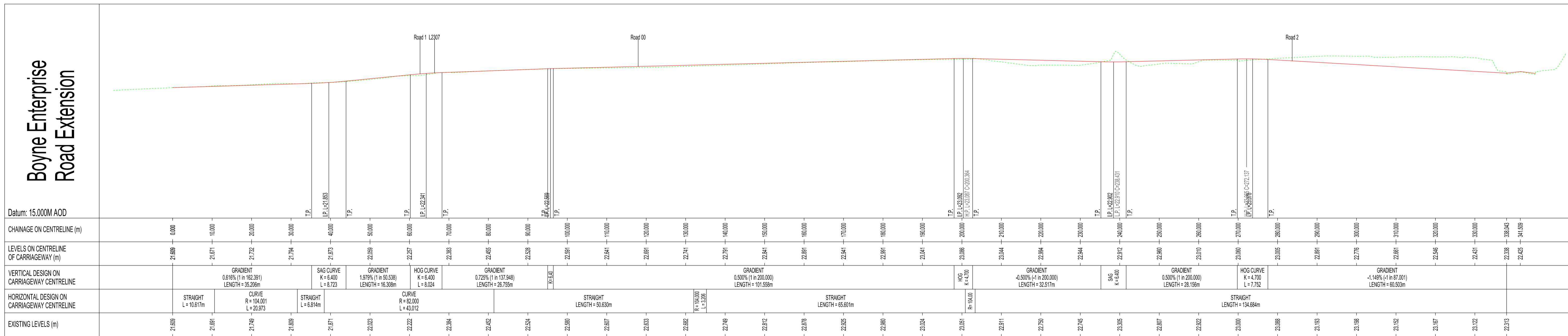

LONGITUDINAL SECTION

HOR SCALE= 1:500
VER SCALE= 1:100

Newtown Link Road

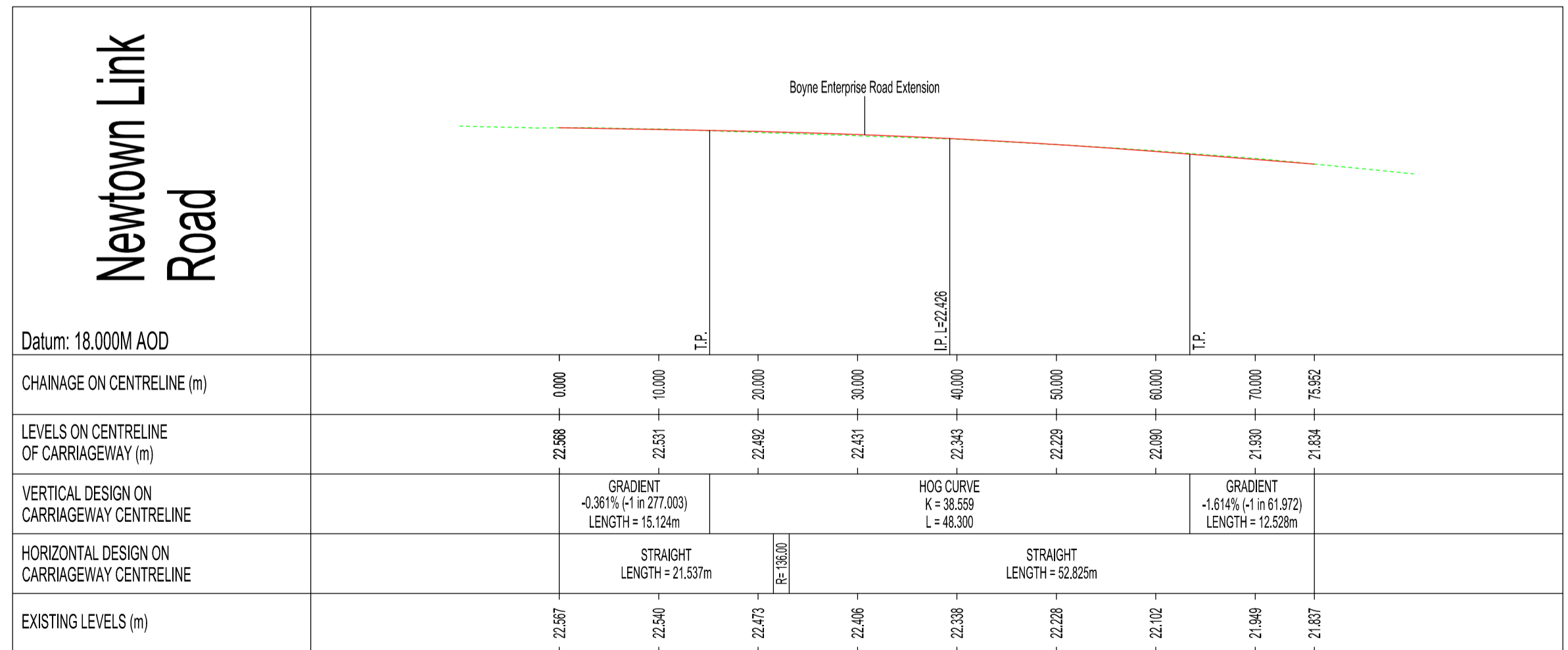

LONGITUDINAL SECTION

HOR SCALE= 1:500
VER SCALE= 1:100

L2307

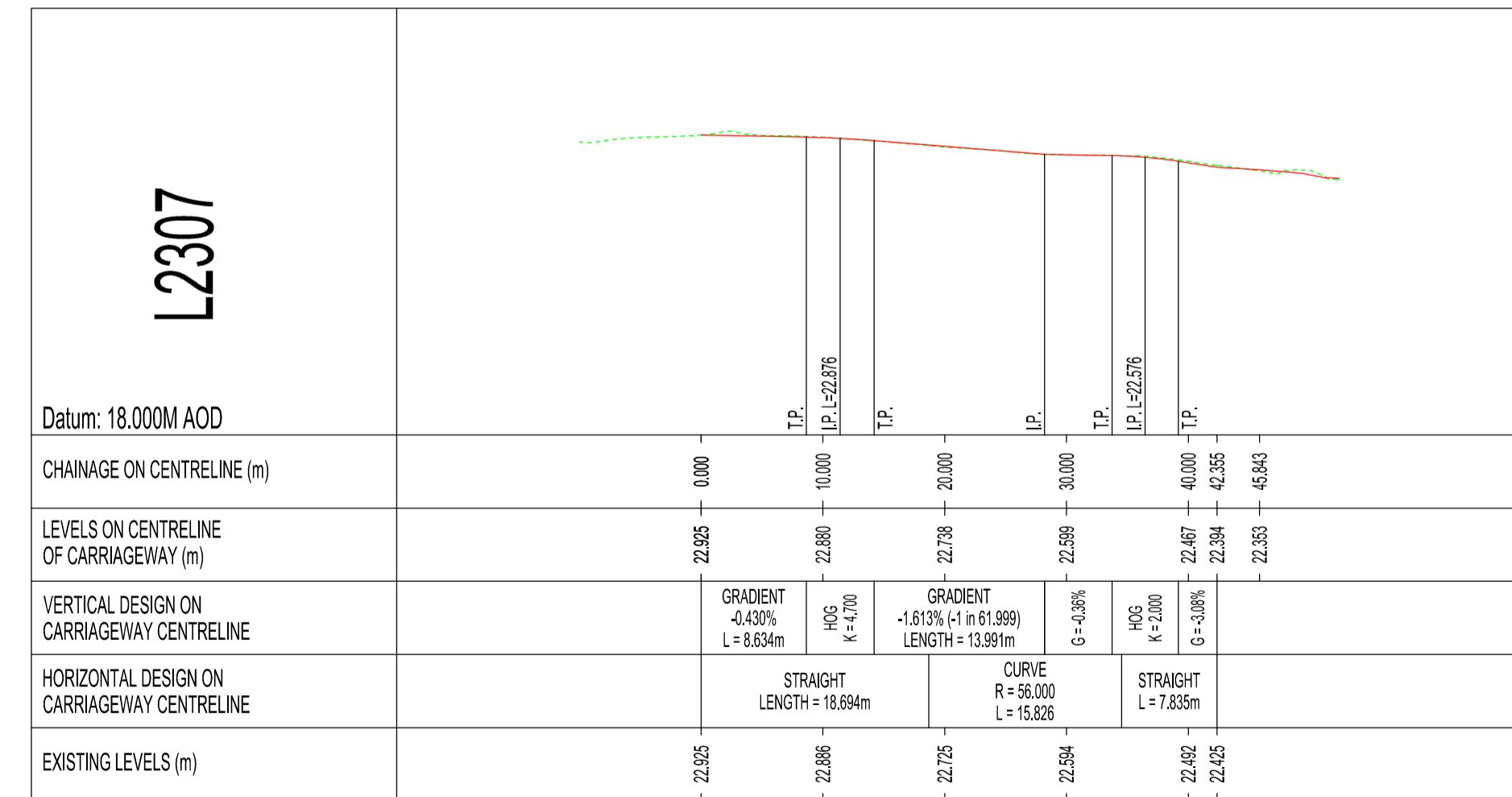

LONGITUDINAL SECTION

HOR SCALE= 1:500
VER SCALE= 1:100

THIS DRAWING TO BE READ IN CONJUNCTION WITH ALL OTHER ARCHITECTURAL AND ENGINEERING DRAWINGS AND ALL OTHER RELEVANT DRAWINGS AND SPECIFICATIONS.
DO NOT SCALE THIS DRAWING. USE FIGURED DIMENSIONS ONLY.
NO PART OF THIS DOCUMENT MAY BE REPRODUCED OR TRANSMITTED IN ANY FORM OR STORED IN ANY RETRIEVAL SYSTEM OF ANY NATURE WITHOUT THE WRITTEN PERMISSION OF O'CONNOR SUTTON CRONIN AS COPYRIGHT HOLDER EXCEPT AS AGREED FOR USE ON THE PROJECT FOR WHICH THE DOCUMENT WAS ORIGINALLY ISSUED.

Rev No.	Date	Revision Note	Drn by	Chkd by
P01	14.05.21	SUITABLE FOR INFORMATION	RF	JM
P02	14.05.21	UPDATED CREST	JM	BH
P03	14.05.21	PART 8 DRAWINGS	JM	BH

Rev No.	Date	Revision Note	Drn by	Chkd by

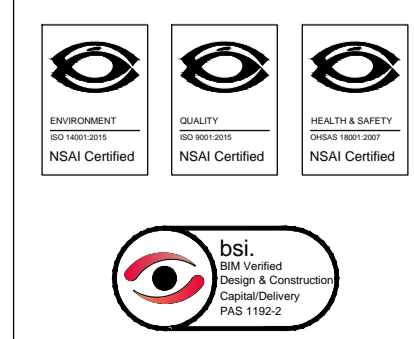

Head Office,
9 Prussia Street,
Dublin 7,
D07 K157

TEL +353 (0)1 8682000
e: contactus@ocsc.ie
w: www.ocsc.ie

Dublin | London | Belfast | Galway | Cork | Birmingham



Client: LOUTH COUNTY COUNCIL
Project: BOYNE ENTERPRISE ROAD EXTENSION

Title: PART 8 DRAWINGS
LAYOUT PLAN AND
LONGITUDINAL SECTION

Code | Originator | Zone | Level | Type | Role | Number | Status | Revision
L320 - OCSC - XX - XX - DR - C - 0005 | S2 | P03
Date: 22.02.21 Scale: 1:500 @ A1 Drn by:LS Chkd by:JM Aprvd by:BO'R